

**Explanation of graphic symbols on package:**



Minimum shelf life



Batch code



Manufacturer



Please read the instructions



Temperature range



Certified medical device



Disposable packaging. Dispose of used packaging in appropriate waste receptacle.



Packaging can be recycled



A fee for the national packaging management system has been paid for this packaging.

**Enterogel®**  
**is a patent of Swiss company**  
**Bioline Pharmaceutical**



**Manufacturer:**



Bioline Products s.r.o., Krakovská 1338/10,  
110 00 Prague 1, Czech Republic  
tel./fax: + 420 266 317 783  
e-mail: info@enterosgel.eu  
[www.enterosgel.eu](http://www.enterosgel.eu)

**Distributor in Australia**

Medsilica Australia Pty. Ltd  
55 Oceano St, Copacabana  
NSW 2251, Australia  
Freephone: 1800 757 700  
info@medsilica.com  
[www.medsilica.com](http://www.medsilica.com)

**Distributor in New Zealand**

Medsilica Ltd  
9 Walford Drive, Lynmore, Rotorua, 3010,  
New Zealand  
Freephone: 0800 757 700  
info@medsilica.com  
[www.medsilica.com](http://www.medsilica.com)

**Distributor in Australia**

**VIC NSW QLD**  
EnterosOZ Pty Ltd  
114 Thistle Street, Gordon Park Qld 4031  
Phone: 1300 436 382  
orders@enterosoz.com.au  
[www.enterosOZ.com.au](http://www.enterosOZ.com.au)

- ✓ acute gastroenteritis (disease-associated diarrhoea) in adults and children
- ✓ allergic diseases with gastrointestinal symptoms in adults and children
- ✓ irritable bowel syndrome with diarrhoea (IBS-D)



**ENTEROSGEL**

**For Children & Adults**  
**Non-allergenic**

Medical device  0088

## Patient Information Leaflet



For Children & Adults • Non-allergenic

**Enterosgel® is free from preservatives, colouring, gluten, fat, sugar, lactose, flavours and sweeteners.**

Please read this Leaflet carefully before you start taking Enterosgel®. Keep this Leaflet. You may need to read it again. If you have any further questions, always ask your doctor or pharmacist. You may require tests to check for certain symptoms before any treatment or that the device is suitable for you.

### 1. What is Enterosgel® and what it is used for?

Enterosgel® is an innovative intestinal adsorbent developed for binding toxins, allergens, pathogens and other harmful substances in the gastrointestinal tract, to help remove them from the body.

ENTEROSGEL® is to be used as ancillary treatment to other standard management therapies for acute enteric intestinal complaints, such as:

- ✓ **Acute diarrhoea (Gastroenteritis).**
- ✓ **Allergies with gastrointestinal symptoms** (Not used for treatment of anaphylactic shock)
- ✓ **Irritable Bowel Syndrome with diarrhoea (IBS-D).**

### 2. How should I take Enterosgel®

#### Enterosgel® in a tube:

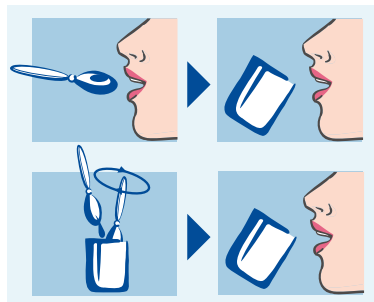

#### Enterosgel® in a sachet:

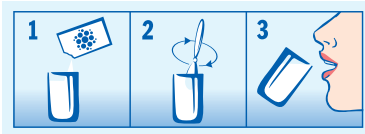

#### Directions for Use

Read leaflet before use. Always consult a Doctor or Pharmacist to check if this product is suitable for you. Do not use the Device as an alternative to the standard treatment. If symptoms persist seek further medical advice.

Age	Dosage	How Often
Child 1-6 years old	1 teaspoon or 5g	3 times a day
	or 1/3 of sachet	
Child 7-14 years old	2 teaspoons or 10g	3 times a day
	or 1/2 of sachet	
15+ and adults	1-1.5 tablespoons or 15-22.5g	3 times a day
	1-1.5 sachet	

- Shake well before opening.
- For children 1 to 3 years old Enterosgel® can be used under advice of a doctor. Enterosgel® should be administered orally 1-2 hours before or after a meal. When this product is taken it is recommended to wash it down with sufficient quantity of water or dilute the dose in water of room temperature prior to its administration (in 200 ml of water for adults and children aged 7 and over, 50-100 ml of water for children aged 1-6).
- Enterosgel® may affect the absorption of some medicines that are administered orally – use Enterosgel® 1-2 hours before or after taking medication. If you are taking any medication, it is recommended you consult your doctor or pharmacist prior to using Enterosgel®.

#### 3. Contraindications

Intestinal atony (severe constipation due to bowel obstruction). Intolerance, based on prior use of ENTEROSGEL®.

#### 4. Pregnancy and breastfeeding

Enterosgel® can be taken during pregnancy and breastfeeding. It is recommended to speak to your GP or midwife if you are unwell during pregnancy.

#### 5. Additional information

**Composition:** polymethylsiloxane polyhydrate (methylsilicic acid hydrogel) – 70%, water purified – 30%.

#### Packaging:

Enterosgel® is an oral suspension (a soft paste that you take by mouth) and it comes in either a tube or sachet inside a carton in the following pack sizes: 90g tube, 225g tube, 15g sachet (10 sachets per pack).

#### Storage parameters:

Store at temperatures between 4-25 °C.

Do not freeze.

Keep out of the reach of children.

Avoid drying out after opening the package. Use this product within 30 days of opening the tube.

#### Shelf life:

3 years from the date of release. The expiry date is provided on the bottom flap of the carton next to the hourglass symbol.

#### What to do if the package is damaged:

Do not use the product if the seal has been broken, damaged or appears to have been tampered with.

#### 6. Possible side effects

Any treatment can have side effects. Sometime they can be serious, most of the time they are not. Some common side effects that you may experience are nausea, vomiting, constipation. There may be other side effect that occur. Always tell your doctor or pharmacist if you experience anything that is making you unwell while using Enterosgel®.

**Date of last revision:** 9 December 2016